

# Laptop Locker

Keyed, Electronic or Hasp

**CANADIAN**  
**LOCKER COMPANY LIMITED**

(800) 494-9073 or (416) 439-5992

[www.canadianlocker.com](http://www.canadianlocker.com)

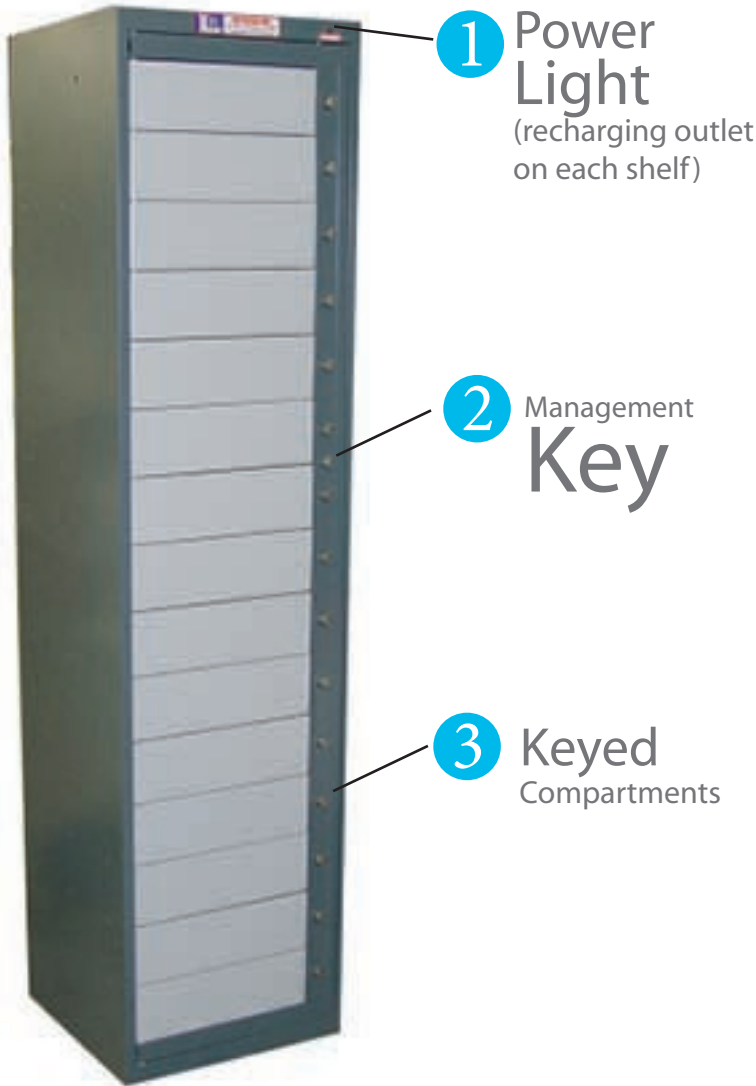

## Ready to install secure Laptop Lockers

- Recharging outlets inside each door
- Administrator access to all compartments
- Proprietary keys and electronic user codes

► **Choose the laptop storage product that best fits your needs.** Offering electronic and key operation. Available with 4, 6, 10 or 15 compartments.

Choose from three operations...

**LTS-15**  
Keyed Operation

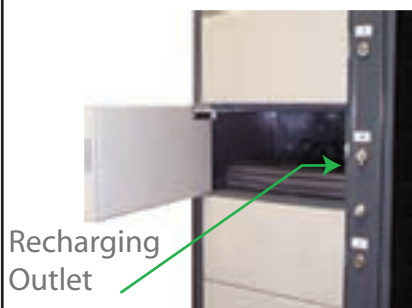

**CLER-15, MCLER-15**  
Electronic Operation



**LTS-15H**  
Hasp Operation

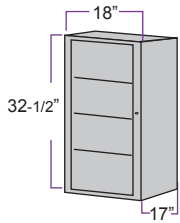
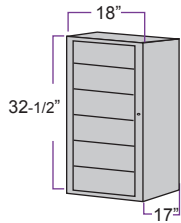
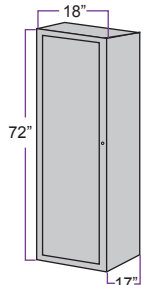
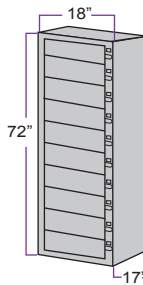
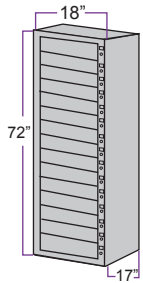
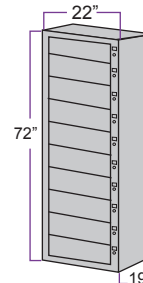

**LTS-4, LTS-4H**Electronic, Keyed or Hasp  
4-compartment**LTS-6, LTS-6H**Electronic, Keyed or Hasp  
6-compartment**LTS-10SD, LTS-15SD**Keyed  
10 or 15 compartment**CLER-10, LTS-10,  
LTS-10H, MCLER-10**Electronic, Keyed or Hasp  
10 compartment**CLER-15, LTS-15,  
LTS-15H, MCLER-15**Electronic, Keyed or Hasp  
15 compartment**CLER-10W, LTS-10W,  
LTS-10WH**Electronic, Keyed or Hasp  
10 compartment

## Specifications

More info at [www.canadianlocker.com](http://www.canadianlocker.com)

### Laptop Lockers

**Materials:** Completely factory assembled by welding body to door frame assembly.

- Locker Body: Fabricated from cold rolled, electro-zinc coated steel sheet.
- Doors: Formed from textured steel reinforce self-closing and equipped with stainless steel pivot or piano type hinge.
- Compartments: Each compartment equipped with electrical receptacle for recharging batteries of stored computers and other electronic items. Provide LED red light indicating system is powered.
- Electrical: Storage unit provided with 6" electrical cord and 3 prong plug at rear, 15 amp circuit breakers and 14 gauge wiring to compartments.

### PDA-14

- Doors: Extruded aluminum, min. thickness of 1/8", max. of 1/4" (must be specified), swings on continuous hinge
- Lock: 5-pin cylinder cam lock.
- Master Door: Swings on continuous hinge, features top to bottom locking bar.
- Compartments: Shelves riveted for added protection. Fourteen compartments equipped at rear with 3-prong electrical receptacles for recharging batteries of PDAs and cell phones.
- Options: 3/4" high number or letter engraved in face of door. Aluminum or plastic door ID tab.

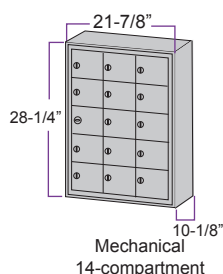
**PDA-14**Mechanical  
14-compartment

### Overall Size

	w	d	h
LTS-4, LTS-4H	18"	17"	32-1/2"
LTS-6, LTS-6H	18"	17"	32-1/2"
LTS-10, LTS-10H, LTS-10SD, CLER-10, MCLER-10	18"	17"	72"
LTS-15, LTS-15H, LTS-15SD, CLER-15, MCLER-15	18"	17"	72"
LTS-10W, LTS-10WH, CLER-10W, MCLER-10W	22"	19"	72"
PDA-14	21-7/8"	10-1/8"	28-1/4"

### Key Chart

=hasp operation  
**LTS**=keyed operation  
**H**

**SD**=single door  
**W**=wide module

### Electronic Operation

**CLER****MCLER**

### Compartment Size

	w	d	h
LTS-4, LTS-4H	12-1/4"	16"	5-1/2"
LTS-6, LTS-6H	12-1/4"	16"	3-1/2"
LTS-10, LTS-10H, LTS-10SD, CLER-10, MCLER-10	12-1/4"	16"	5-1/2"
LTS-15, LTS-15H, LTS-15SD, CLER-15, MCLER-15	12-1/4"	16"	3-1/2"
LTS-10W, LTS-10WH, CLER-10W, MCLER-10W	15-1/4"	18"	5-1/2"
PDA-14	5-7/8"	7-1/2"	4-3/4"

### Laptop Locker Lock Options

#### Key Locking System

- Locks: Security type, single key activation. Keys are among 16 million distinct combinations.
- Compartment Locks: Each compartment keyed separately with keys assigned to individual users.
- Management Control Lock: Each vertical multi-compartment door frame opens with management key to allow access to all compartments for inspection and control.

**Hasp Locking System:** Padlockable hasp unit (padlocks not included)

#### Electronic Access System

- Access Control and Locking System: Electronic lock activated from keypad by entering personal identification code number (7 digits).
- Compartments: Each compartment access by programmed code number. System programmed for multiple codes per compartment
- Management Code: Allows for immediate access to all compartments. Provide mechanical override in event of power failure. System to provide computerized audit trail of usage and access.